

SONIC CLASSIC GRINDING BOOTH



Test TNO Cepro Sonic Classic grinding booth in accordance with EN-ISO 111957

Project number : 008.02382/01.01
 Test date : 17 November 2000

Product : Cepro Sonic Classic grinding booth element
 Test room : TNO TPD 3-4, Delt (The Netherlands)

Test result : $R_w = 29$ dB

Frequency (Hz)	R 1/3 oct (dB)	R 1/3 oct (dB)
50	15,40	
63	10,10	10,50
80	8,60	
100	8,40	
125	11,80	10,60
160	12,80	
200	14,30	
250	18,70	17,30
315	23,10	
400	25,90	
500	30,20	28,70
630	32,80	
800	34,20	
1000	34,40	34,40
1250	34,50	
1600	34,00	
2000	32,30	31,70
2500	29,90	
3150	32,30	
4000	35,60	34,30
5000	35,90	

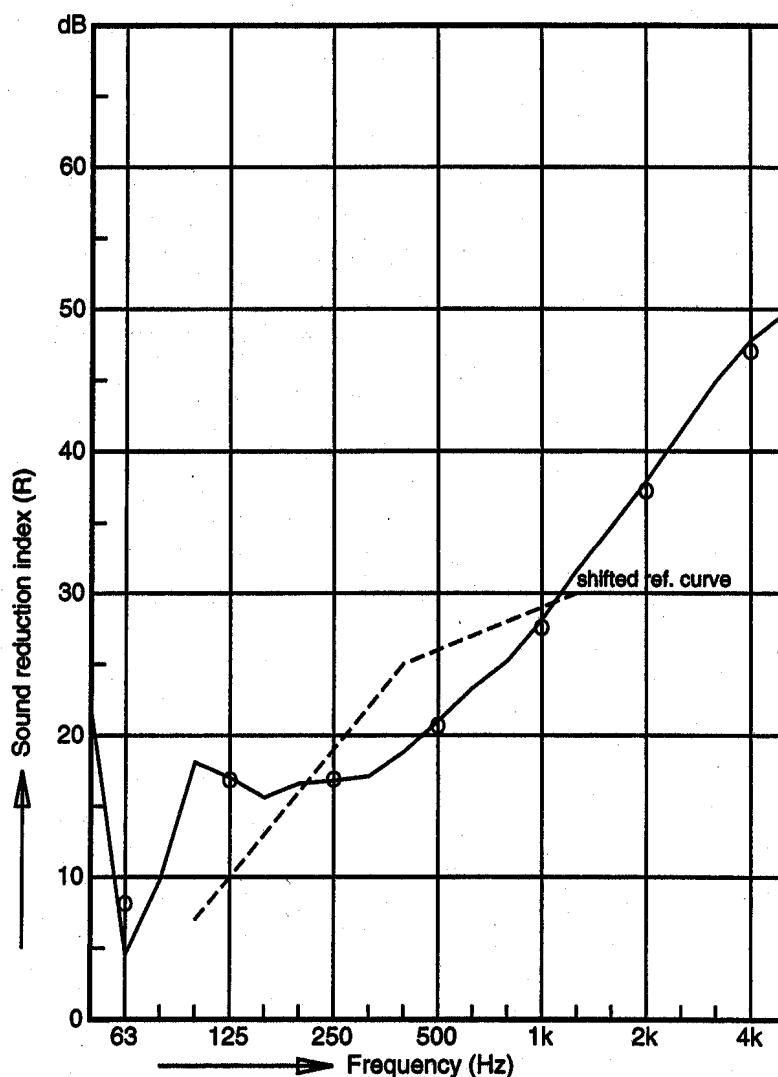

Measurement method

In this test the booth was installed in a reverberation room. The booth was asymmetrically placed on and sealed to the floor of the reverberation room in such a way that no booth wall was parallel to any wall of the room. In the reverberation room 'white noise' is produced using an amplifier-loudspeaker combination. The sound pressure levels in the room have been averaged over two loudspeaker positions and with each loudspeaker position six microphone positions. The sound pressure level in the cabin was measured using a rotating microphone (rotation time 64s) and averaged over the two loudspeaker positions.

SONIC CLASSIC GRINDING BOOTH



COMPOSITION

For steel basic system parts:

- Carbon steel profiles, powder coated.
- Carbon steel non-perforated plate powder coated.
- Filling of two solid mineral fiber panels (2 x 25mm) with a steel plate inbetween.
- Contain no toxic parts.
- Contain no inflammable parts.
- Contain no electrical parts.

USE AND HANDLING

Coating will be damaged by open fire or intensive heat. Oil or grease pollution do not have negative effects on the screens condition.

Dents can occur impact with heavy objects impact against the perforated plate.

MAINTENANCE AND SAFETY

Bolts must be periodic checked. When assemble, take care of a flat and stable surface. The structure is stabilized by attachment to a wall or by the use of corner arrangements.

TECHNICAL SPECIFICATION

Type screen	: Solid noise reducing booth.
Total weight	: 356 kg - 46.05.22 Grinding booth 200x200cm
Total weight	: 794 kg - 46.05.23 Grinding booth 200x200cm
Overall size height	: 2.552 mm.
Width	: 2.118 mm
Depth	: 2.118 mm - 46.05.22 Grinding booth 200x200cm
Depth	: 3.136 mm - 46.05.23 Grinding booth 200x200cm
Materials	: Steel profiles and perforated plate, power coated in green, RAL6011.
Inlay	: 2 x 25mm rock wool 75kg/m ³ with a steel coreplate 0.5mm.
Sound reduction	: Rw = 29 dB (Tested by TNO)
Operation	: Manufactured in factory, easy to assemble and re-assemble on site.

SONIC CLASSIC GRINDING BOOTH



DIMENSIONS GRINDING BOOTH 200 X 200 CM

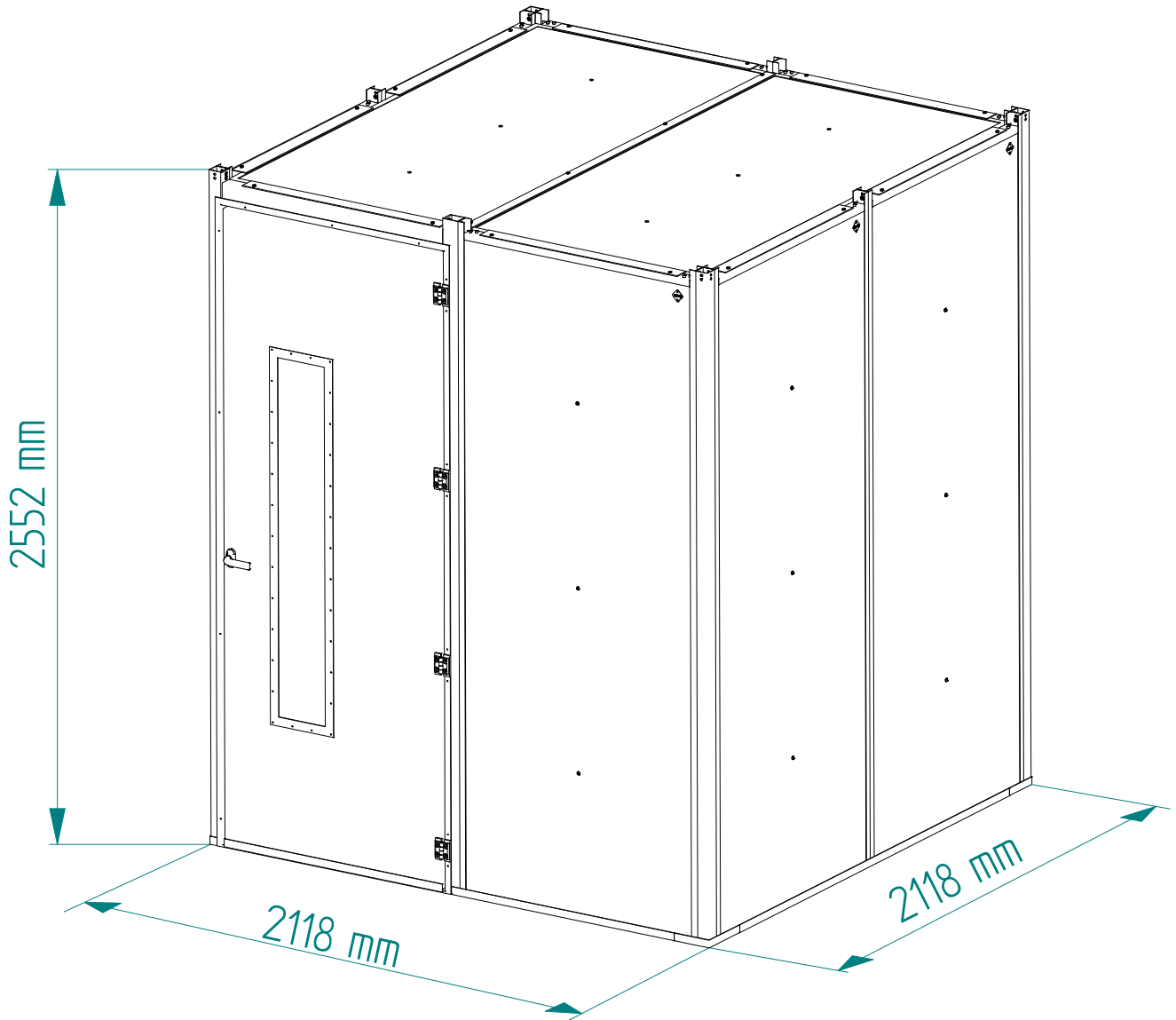

46.05.22 Sonic grinding booth 200 x 200 cm

Version 002 - Check our website for the latest version.

CEPRO_PFS_Sonic_Classic_grinding_booths_2EN

SONIC CLASSIC GRINDING BOOTH



DIMENSIONS GRINDING BOOTH 200 X 300 CM

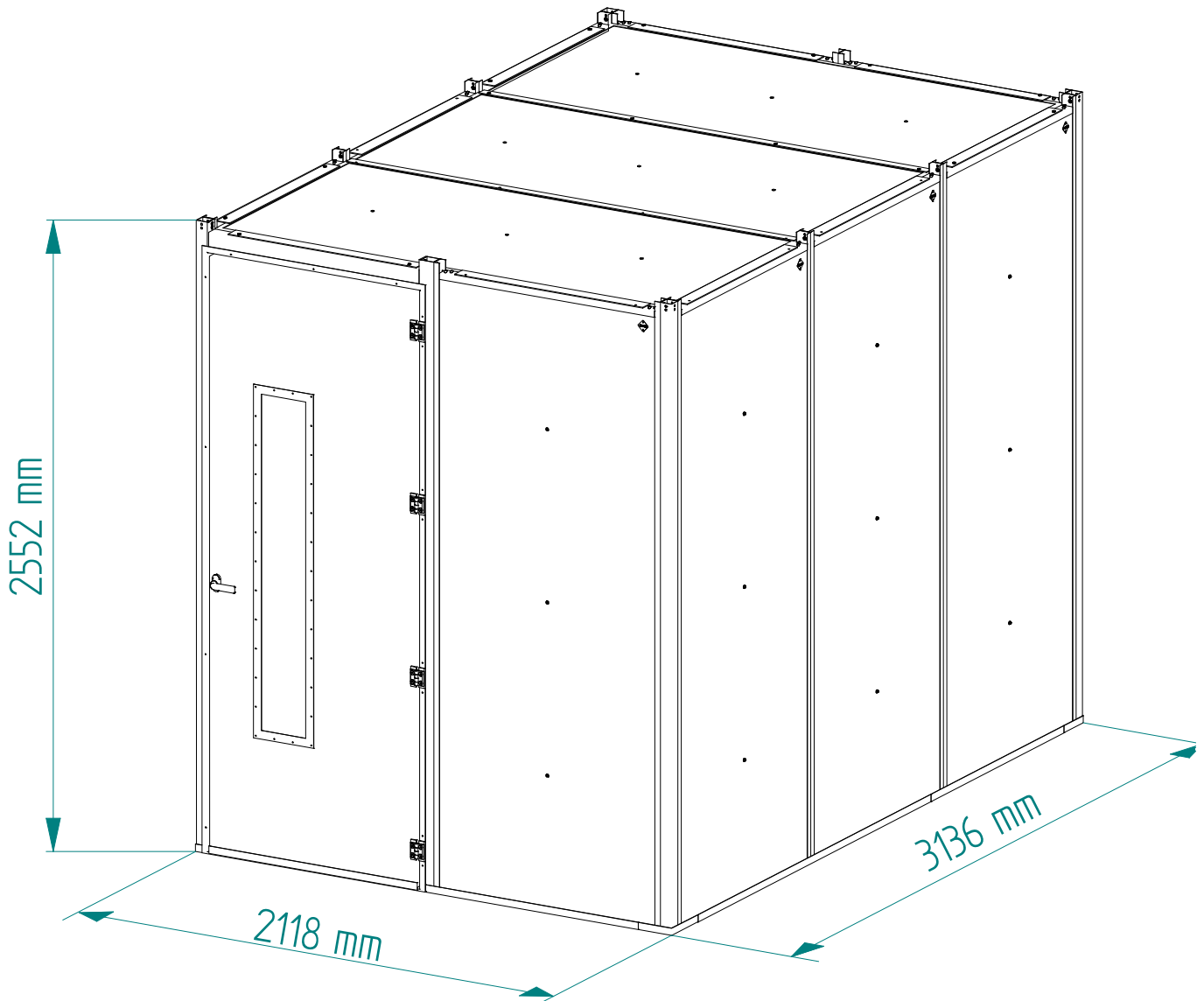

46.05.23 Sonic grinding booth 200 x 300 cm

Version 002 - Check our website for the latest version.

CEPRO_PFS_Sonic_Classic_grinding_booths_2EN

SONIC CLASSIC GRINDING BOOTH



MOUNTING GRINDING BOOTH 200 x 200 CM (46.05.22)

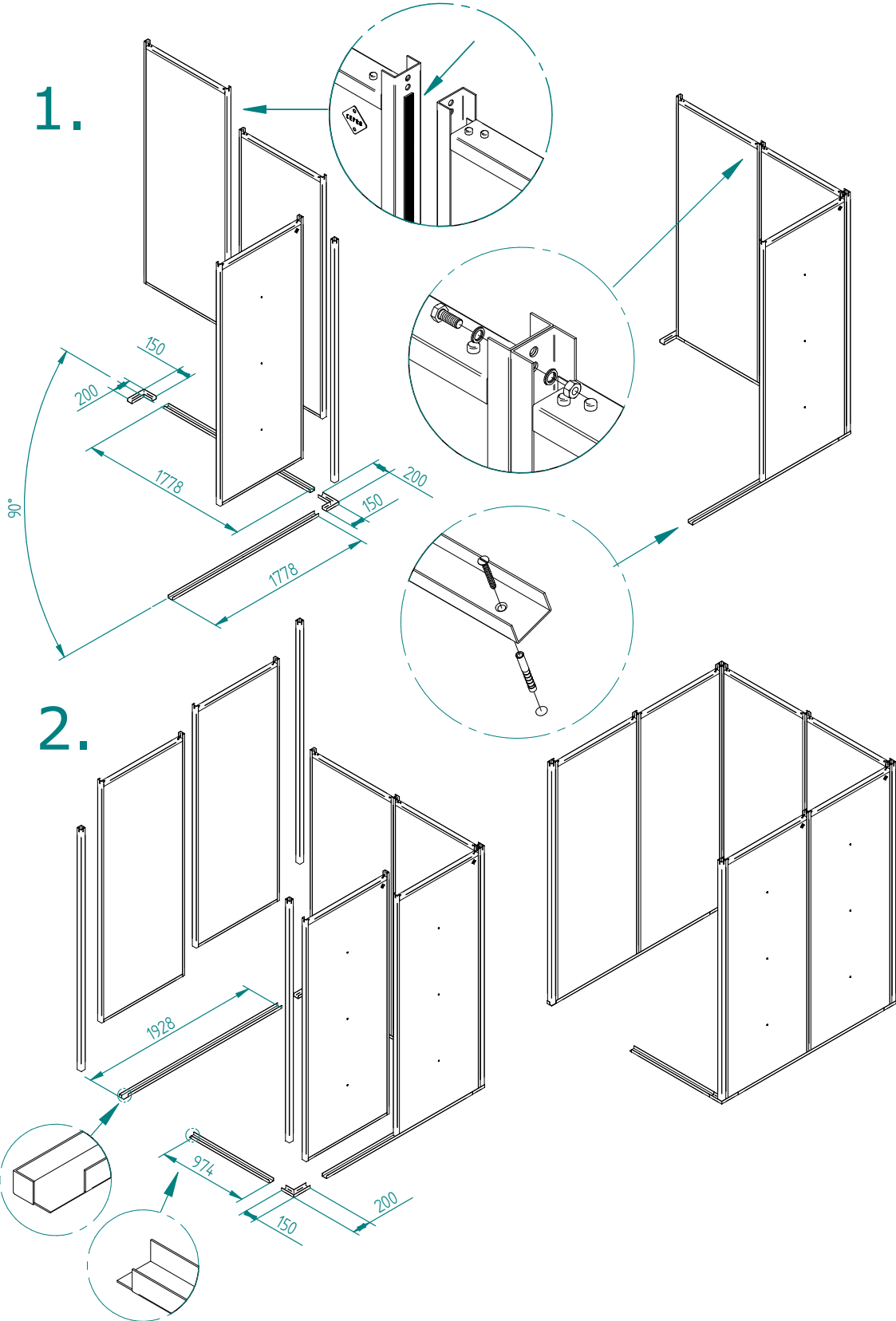

Version 002 - Check our website for the latest version.

CEPRO_PFS_Sonic_Classic_grinding_booths_2EN

SONIC CLASSIC GRINDING BOOTH



MOUNTING GRINDING BOOTH 200 x 200 CM (46.05.22)

3.

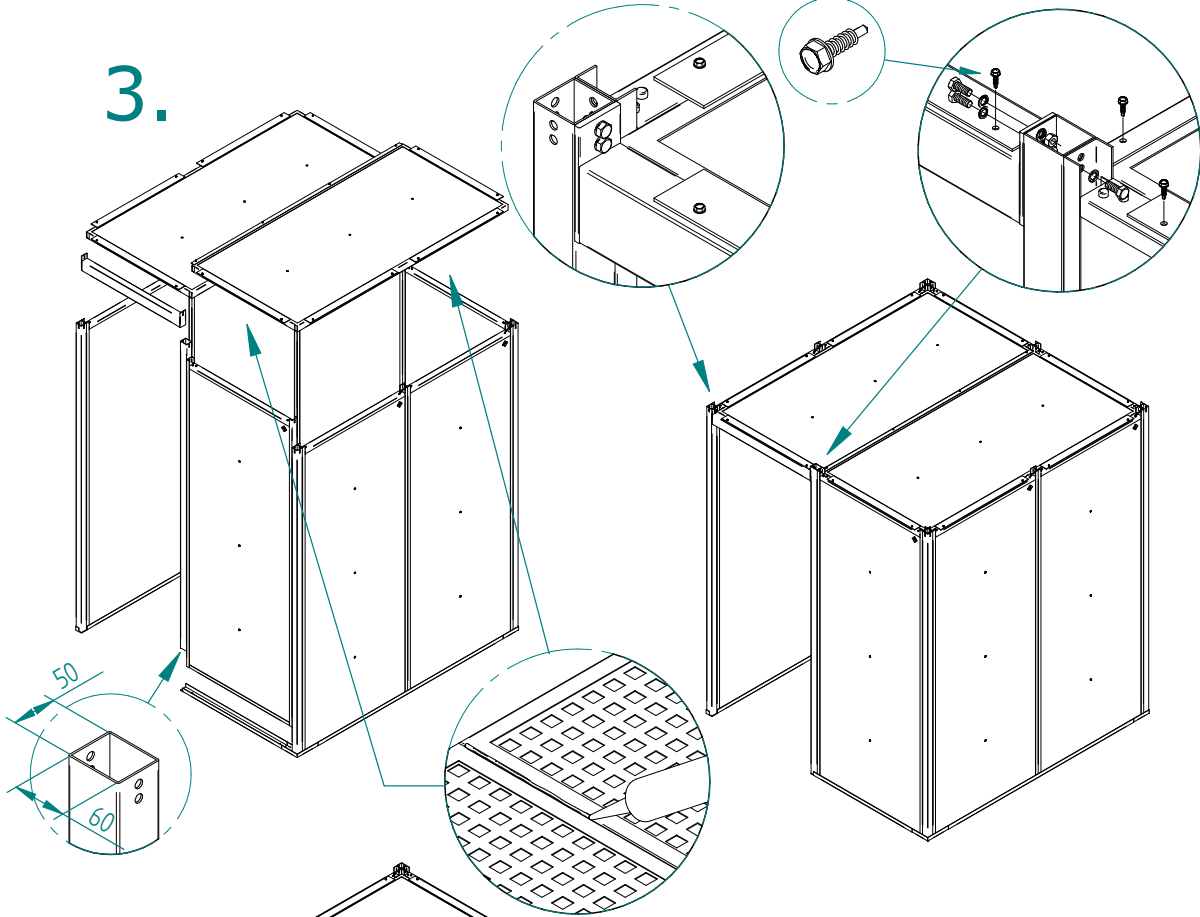

4.

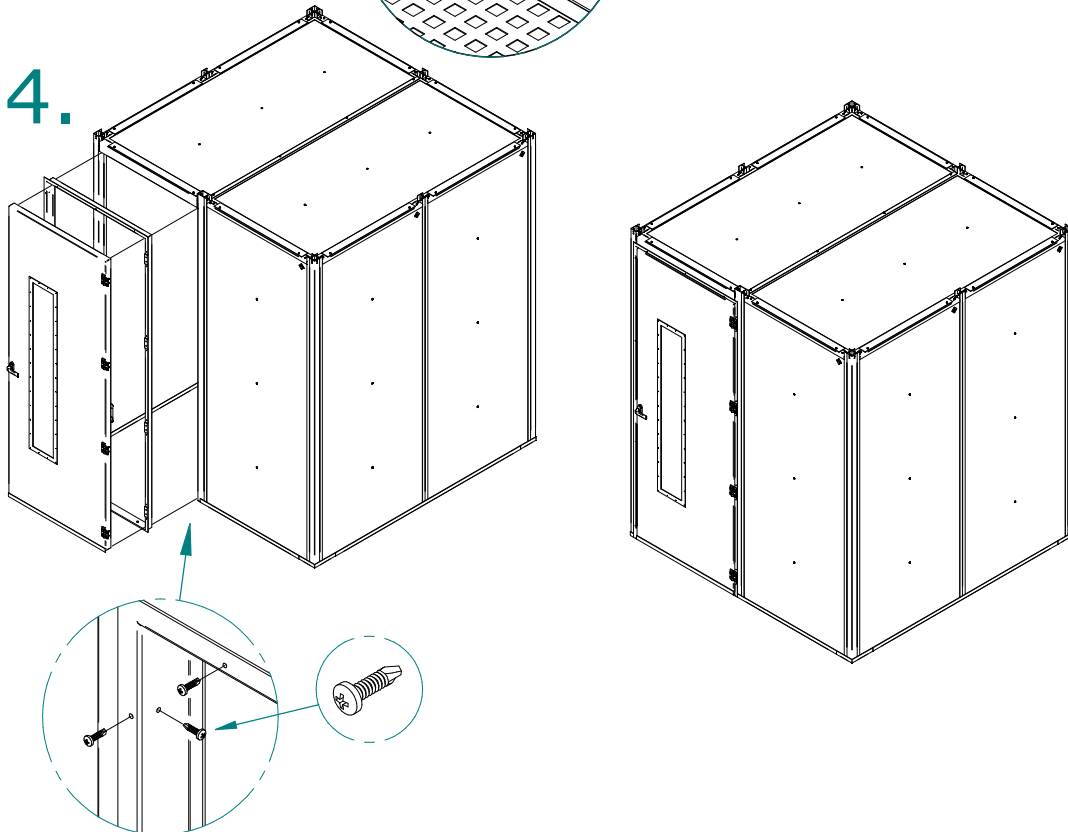

SONIC CLASSIC GRINDING BOOTH



MOUNTING GRINDING BOOTH 200 x 200 CM (46.05.22)

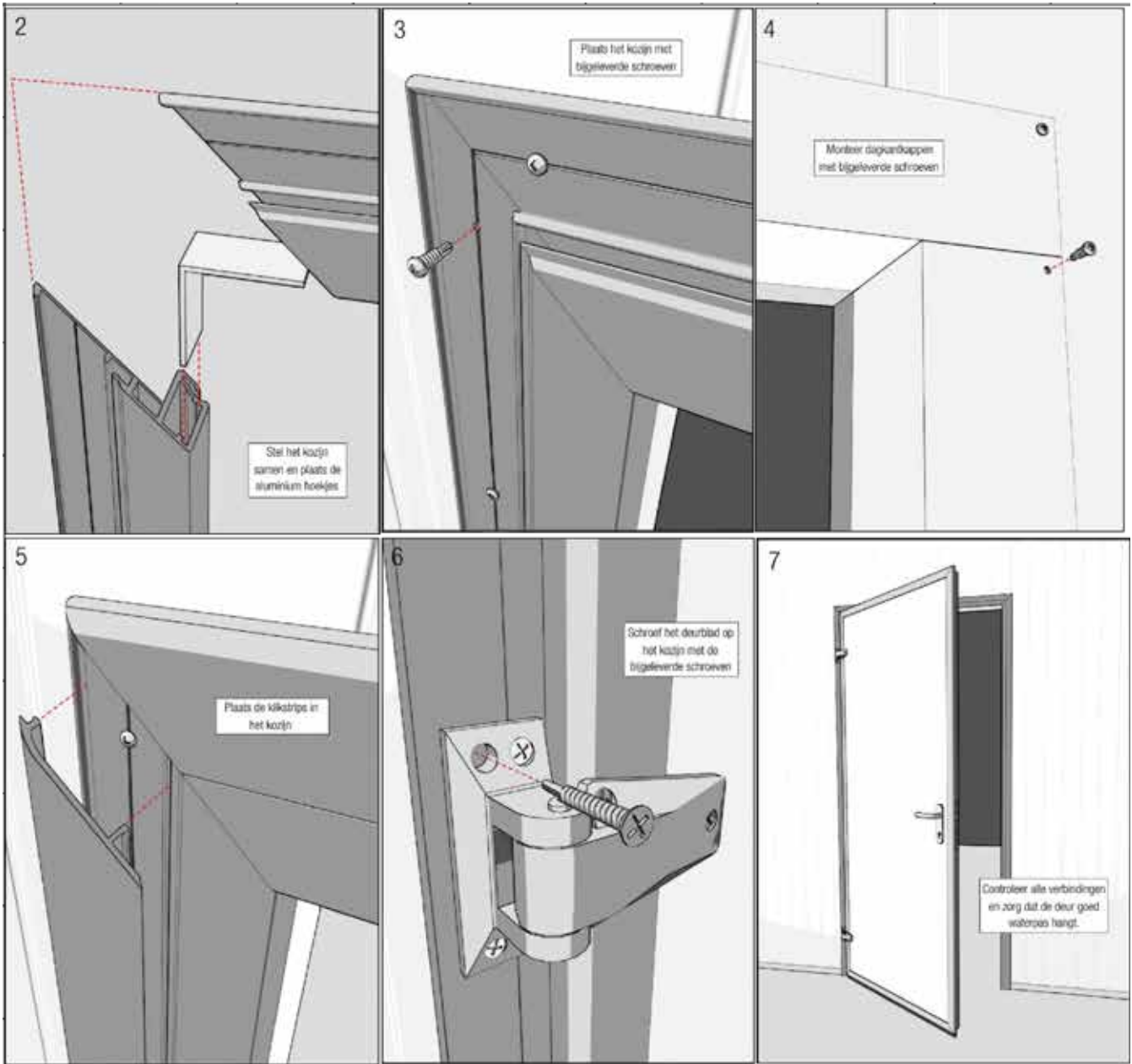

SONIC CLASSIC GRINDING BOOTH



MOUNTING GRINDING BOOTH 200 x 200 CM (46.05.22)



SONIC CLASSIC GRINDING BOOTH



MOUNTING GRINDING BOOTH 200 x 200 CM (46.05.22)

45.00.00.2510	45.20.11.0002	45.20.11.0003	45.21.03			
7 x	4 x	1 x	1 x			
45.01.00.2010	45.01.00.2010	45.21.02	45.21.00.1778			
1 x	1 x	3 x	2 x			
45.21.00.0974	45.21.00.1928	46.90.01.0010				
1 x	1 x	1 x				
M8 x 20	M8	M8	Ø4,9 x 19	Ø4,9 x 19	silicone	5 x 15
DIN933	DIN125-1A	DIN934				
14 x	14 x	14 x	20 x	30 x	1 x	30 mt.

SONIC CLASSIC GRINDING BOOTH



MOUNTING GRINDING BOOTH 200 x 200 CM (46.05.22)

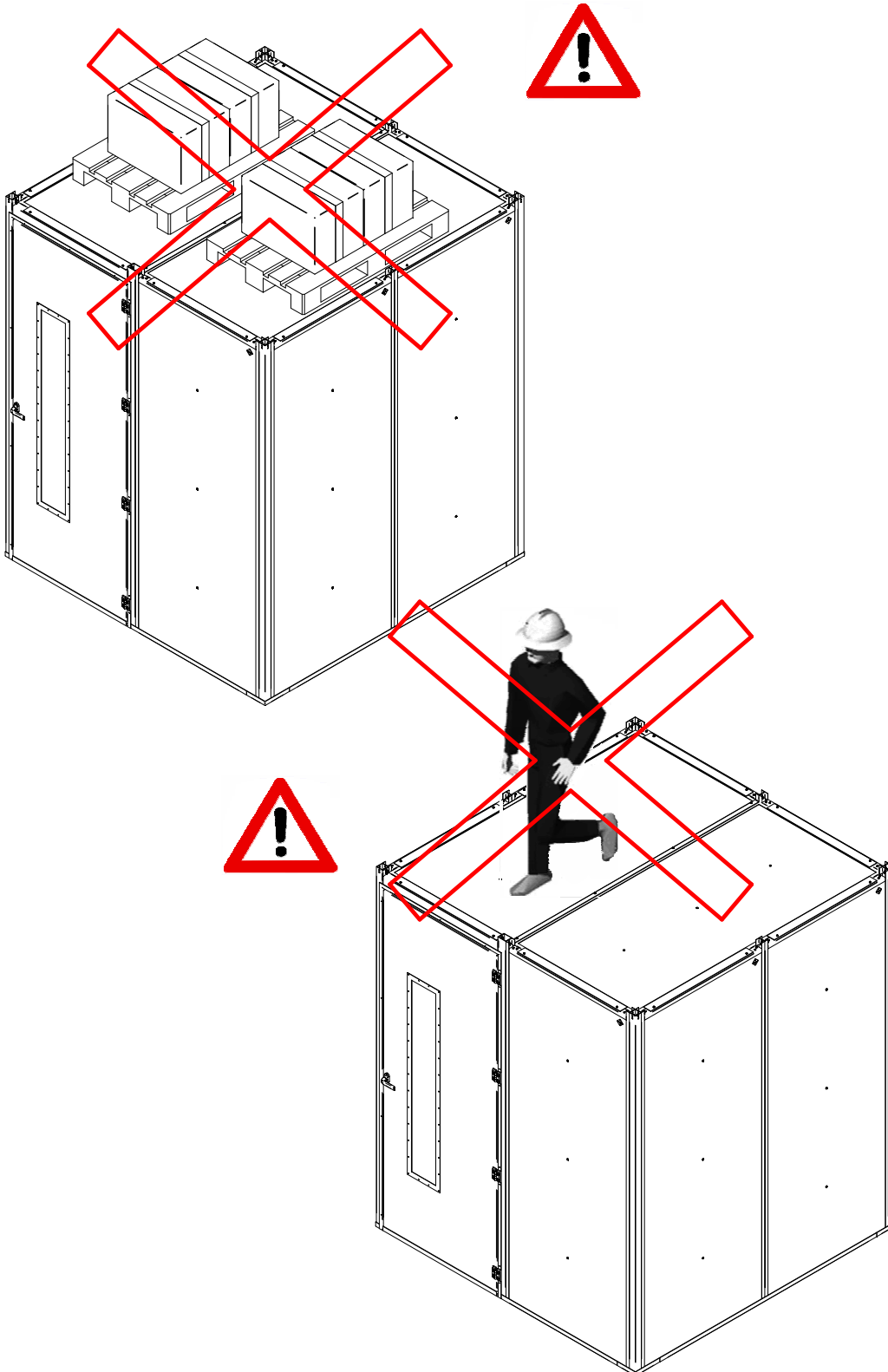

Version 002 - Check our website for the latest version.

CEPRO_PFS_Sonic_Classic_grinding_booths_2EN

SONIC CLASSIC GRINDING BOOTH



MOUNTING GRINDING BOOTH 200 x 300 CM (46.05.23)

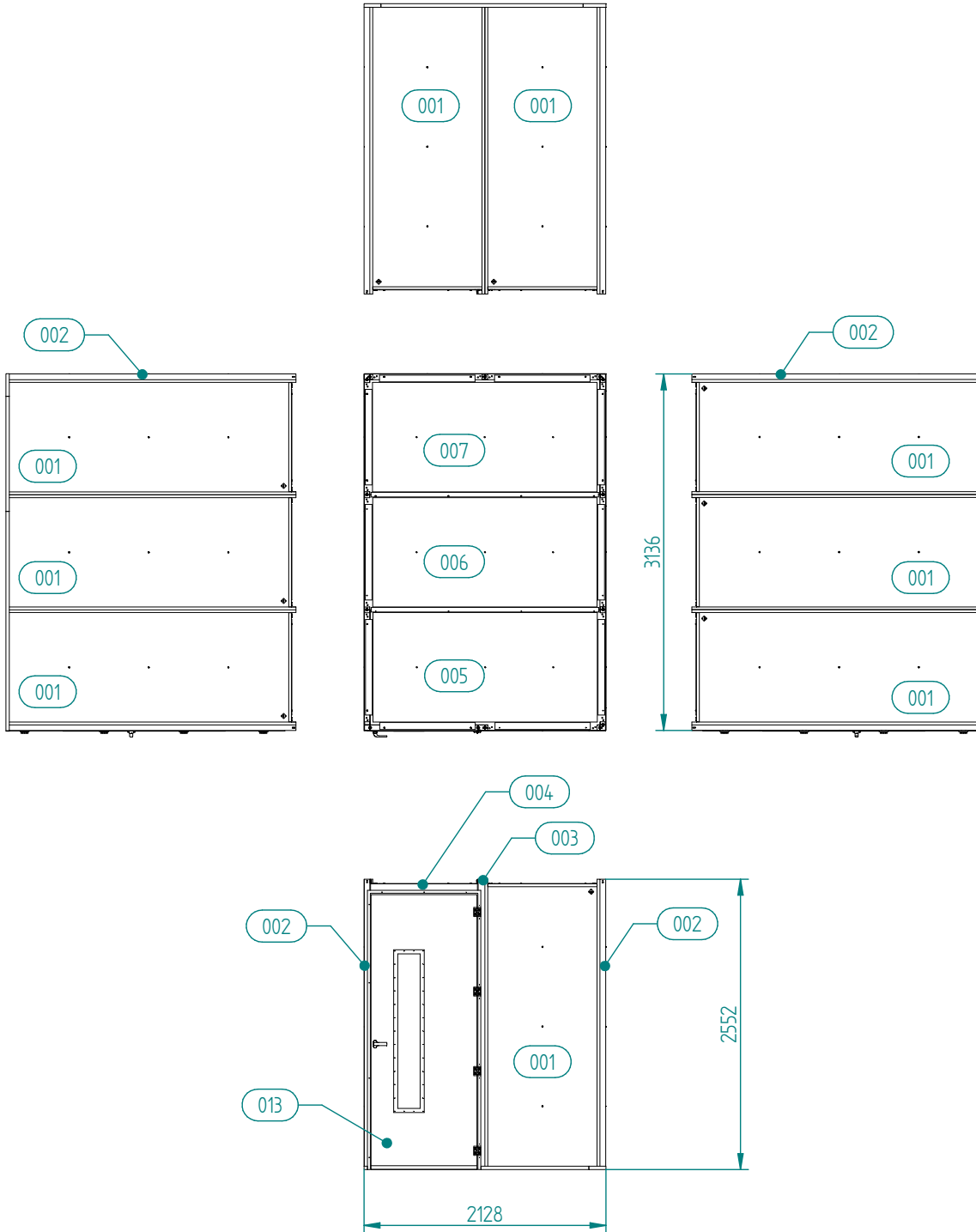

Version 002 - Check our website for the latest version.

CEPRO_PFS_Sonic_Classic_grinding_booths_2EN

SONIC CLASSIC GRINDING BOOTH



MOUNTING GRINDING BOOTH 200 x 300 CM (46.05.23)

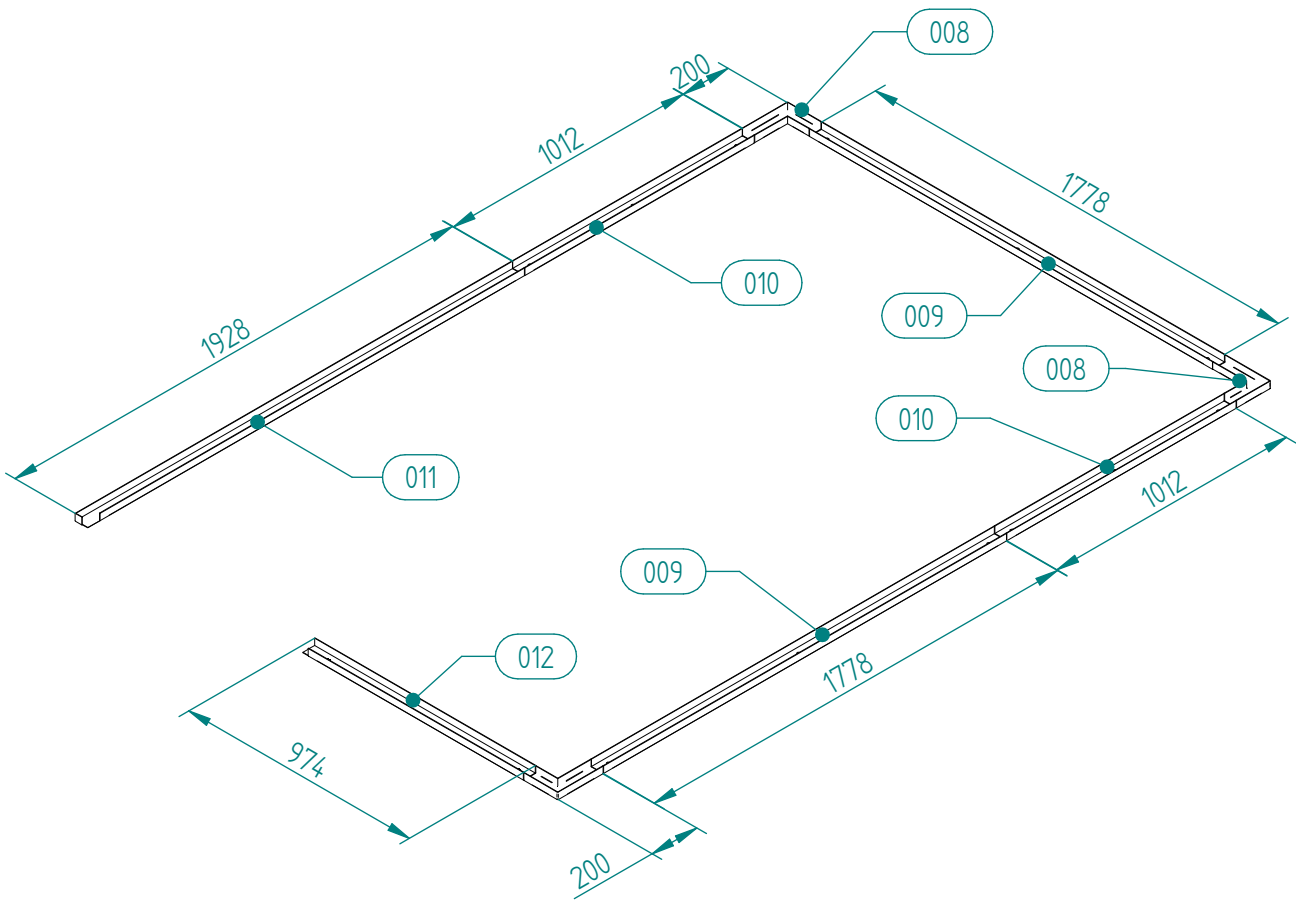

Version 002 - Check our website for the latest version.

CEPRO_PFS_Sonic_Classic_grinding_booths_2EN

SONIC CLASSIC GRINDING BOOTH



MOUNTING GRINDING BOOTH 200 x 300 CM (46.05.23)

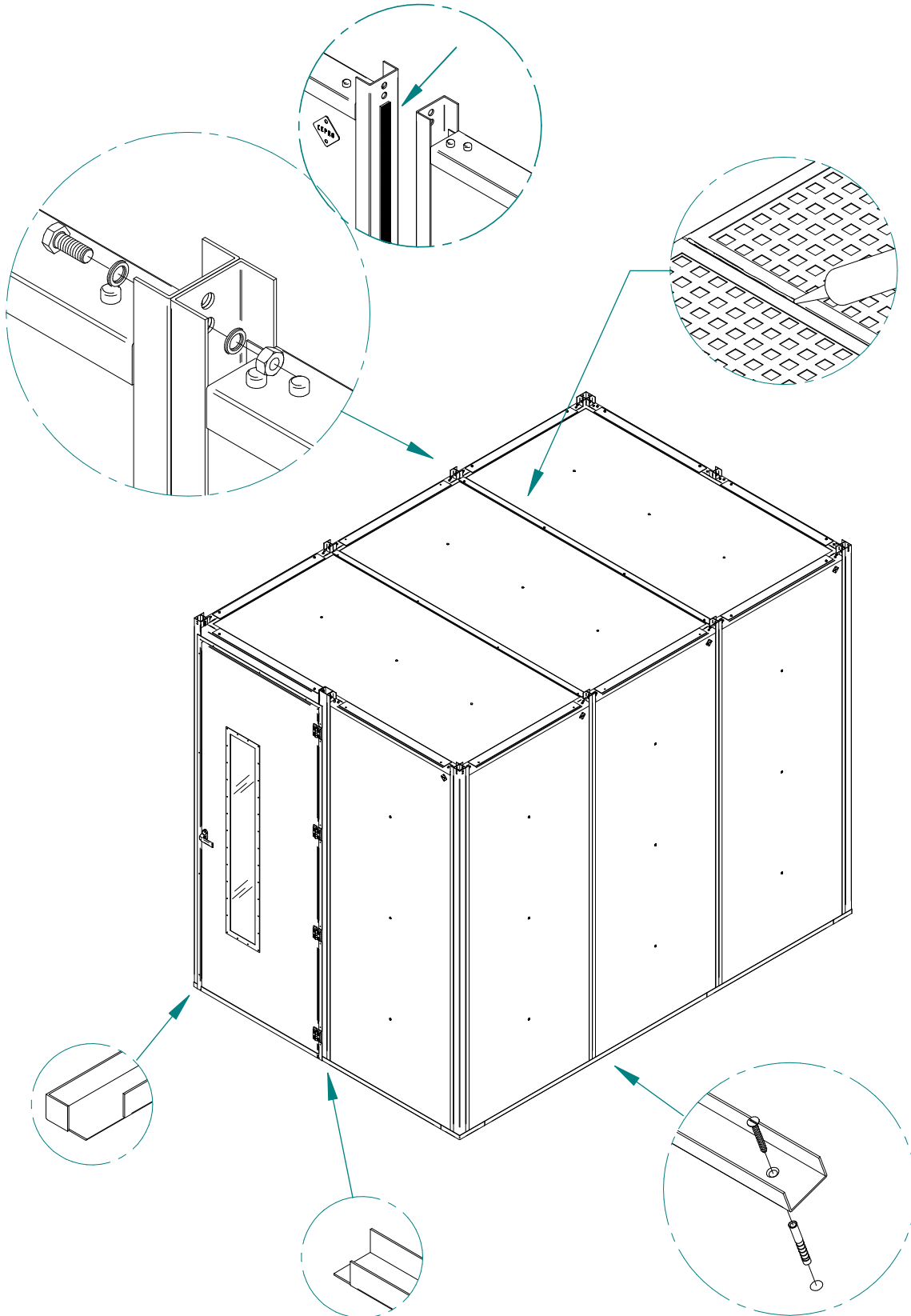

Version 002 - Check our website for the latest version.

CEPRO_PFS_Sonic_Classic_grinding_booths_2EN

SONIC CLASSIC GRINDING BOOTH



MOUNTING GRINDING BOOTH 200 x 300 CM (46.05.23)

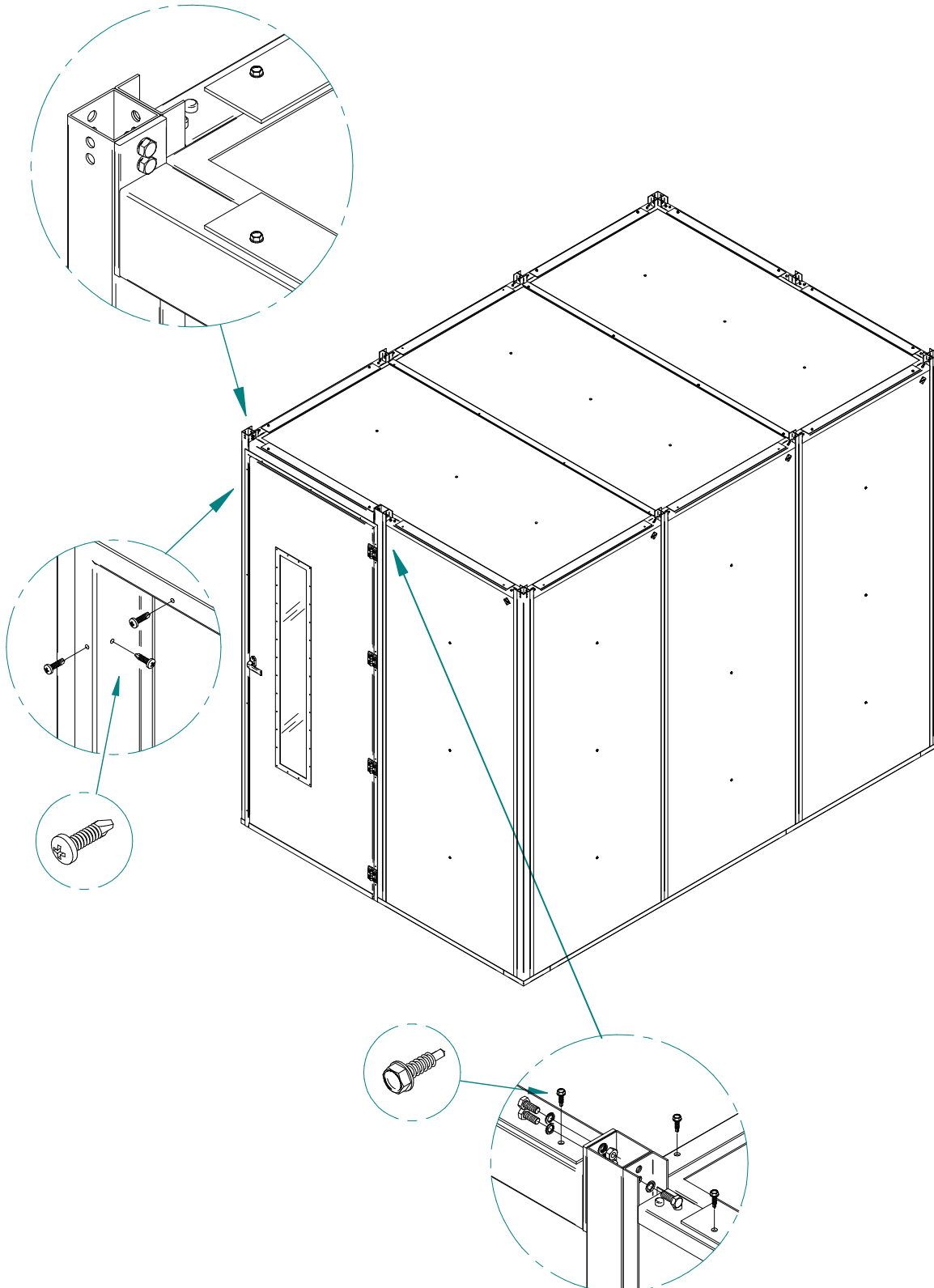

Version 002 - Check our website for the latest version.

CEPRO_PFS_Sonic_Classic_grinding_booths_2EN

SONIC CLASSIC GRINDING BOOTH



MOUNTING GRINDING BOOTH 200 x 300 CM (46.05.23)

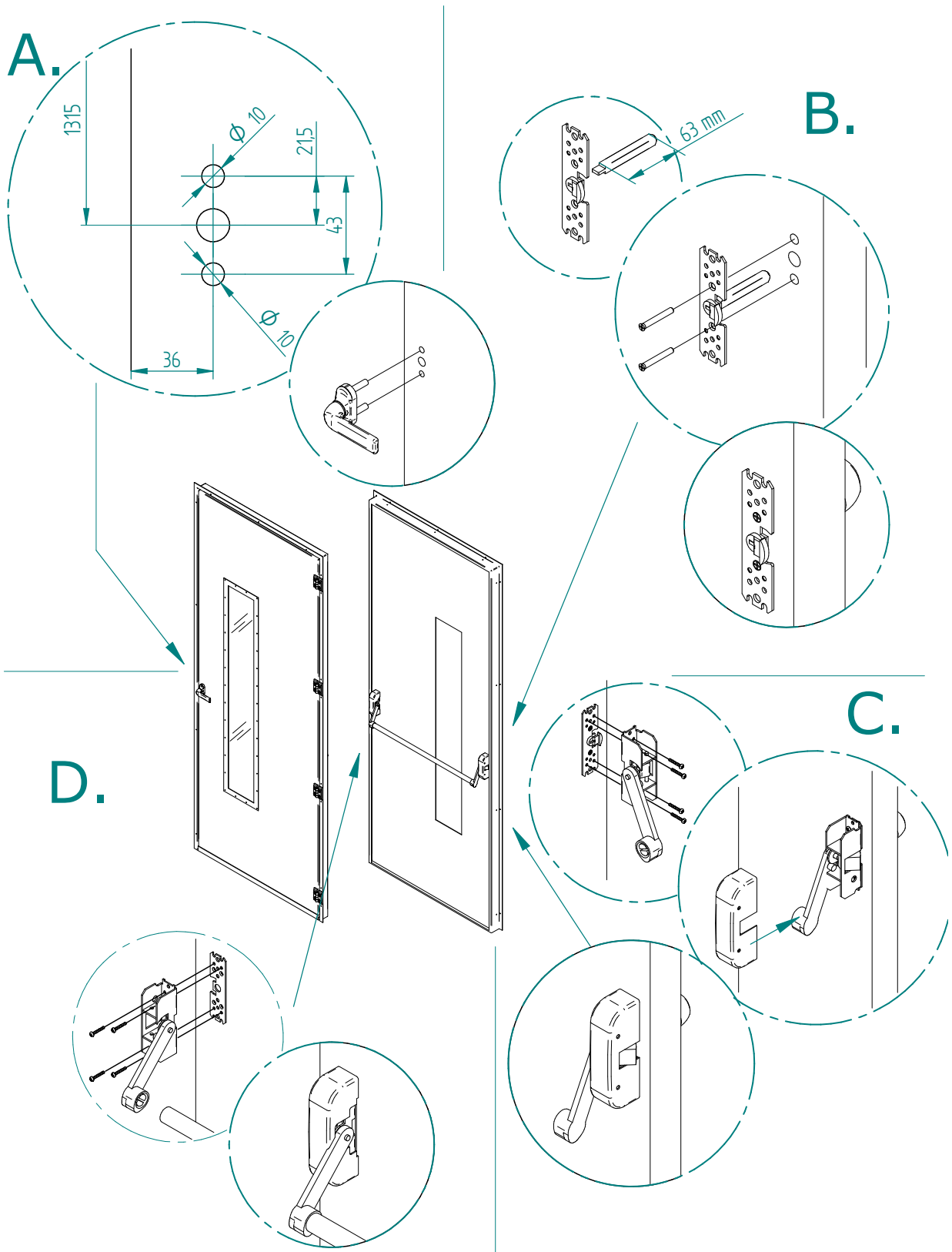

Version 002 - Check our website for the latest version.

CEPRO_PFS_Sonic_Classic_grinding_booths_2EN

SONIC CLASSIC GRINDING BOOTH



MOUNTING GRINDING BOOTH 200 x 300 CM (46.05.23)

pos.001	pos.002	pos.003	pos.004				
45.00.00.2510	45.20.11.0002	45.20.11.0003	45.21.03				
9 x	4 x	1 x	1 x				
pos.005		pos.006	pos.007	pos.008			
45.01.00.2010		45.01.00.2010	45.01.00.2010	45.21.02			
1 x		1 x	1 x	3 x			
pos.009		pos.011	pos.012	pos.013			
45.21.00.1778	45.21.00.1012	45.21.00.1928	45.21.00.0974	46.90.01.0010			
2 x	2 x	1 x	1 x	1 x			
M8 x 20	M8	M8	Ø4,9 x 19	Ø4,9 x 19	silicone	5 x 15	
DIN933	DIN125-1A	DIN934	28 x	30 x	1 x		36 mt.
16 x	16 x	16 x					

SONIC CLASSIC GRINDING BOOTH



MOUNTING GRINDING BOOTH 200 x 300 CM (46.05.23)

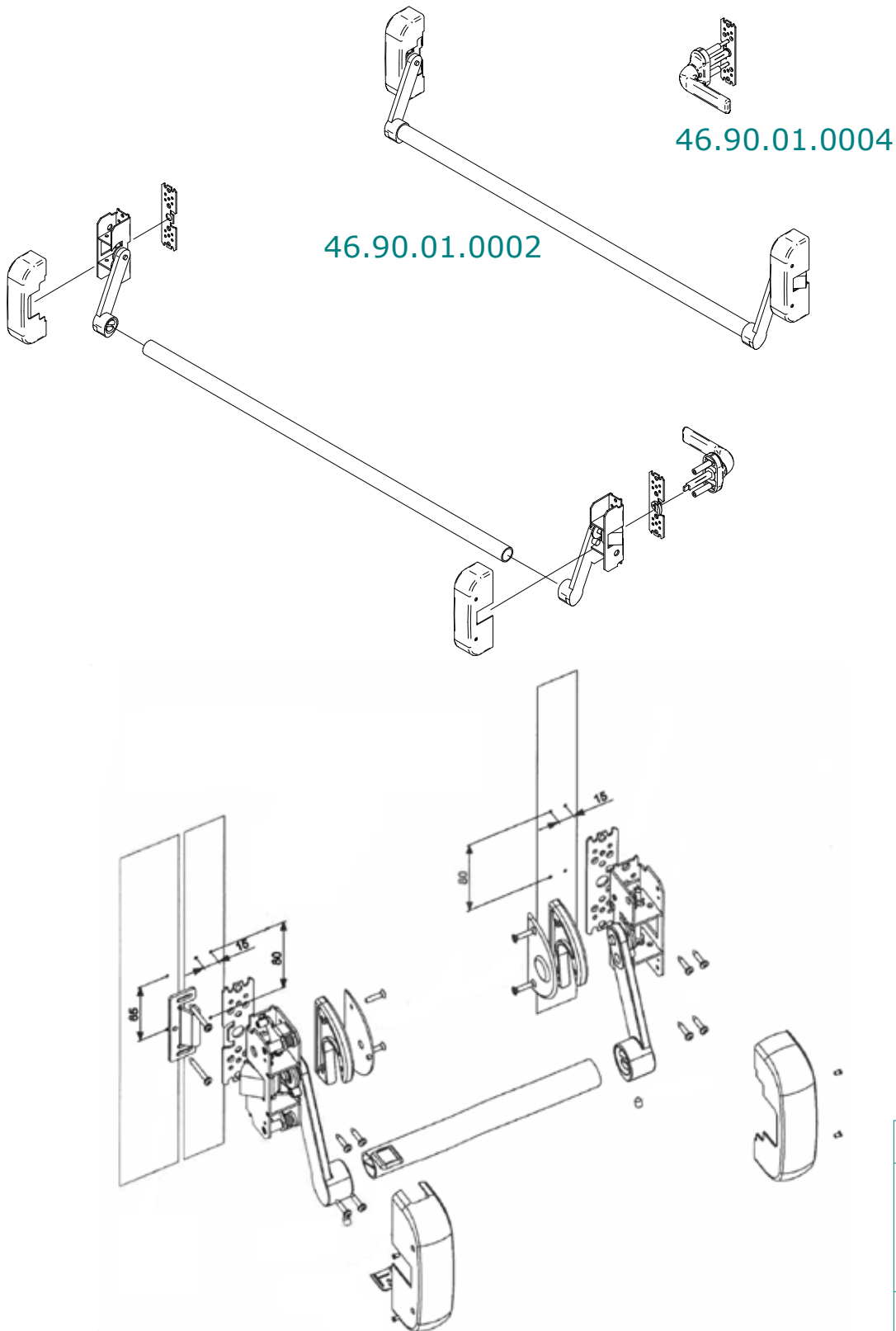

Version 002 - Check our website for the latest version.

CEPRO_PFS_Sonic_Classic_grinding_booths_2EN

SONIC CLASSIC GRINDING BOOTH



MOUNTING GRINDING BOOTH 200 x 300 CM (46.05.23)

